

VERSION	CHANGE CONTENT	DATE
V00	FIRST ISSUE	2011-05-04

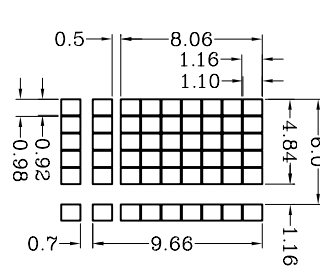
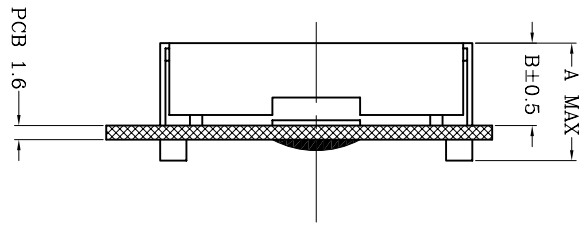
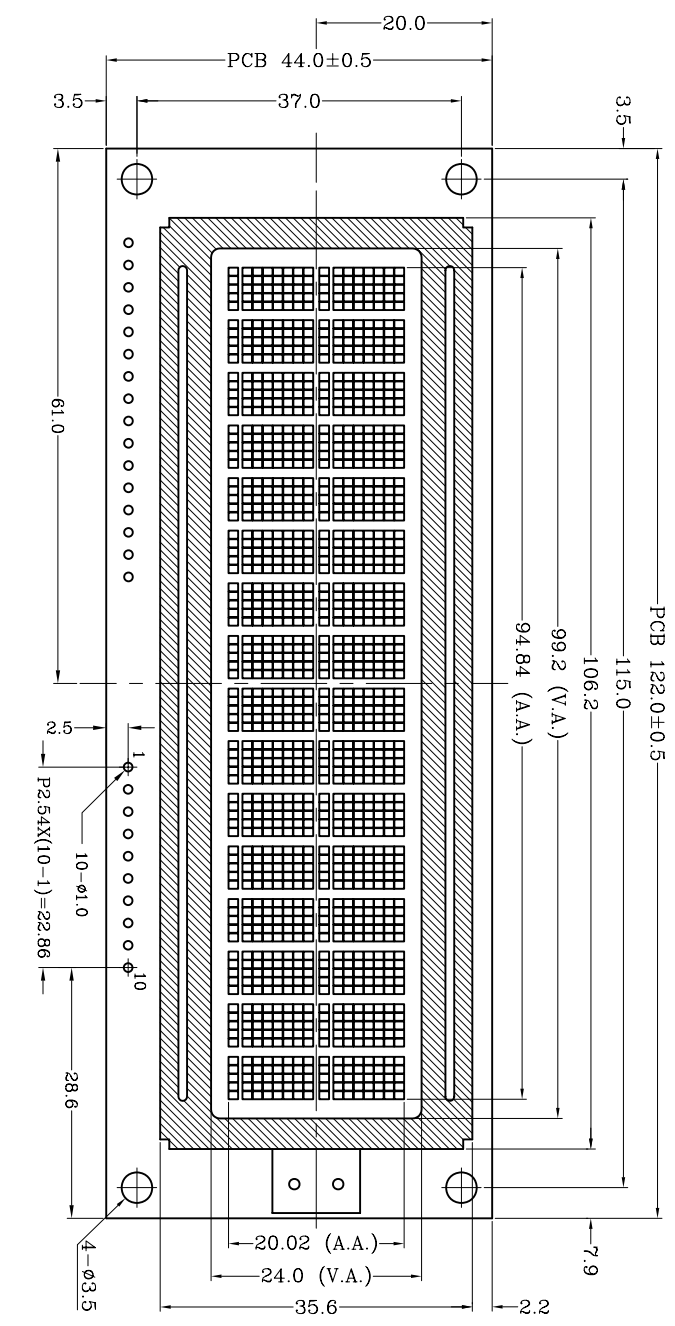

TYPE	A	B
LED B/L	13.9	9.4

DETAIL DOTS  
SCALE: 2:1

PIN	1	2	3	4	5	6	7	8	9	10
NAME	VSS	VDD	V0	/CS	CLK	SI	RS	/RST	LED+	LED-

VIEWING →

SPECIFICATIONS

1. DISPLAY TYPE: STN/TRANSFLECTIVE/POSITIVE-Y-G
2. LCD DRIVING VOLTAGE: 3.0V
3. LOGIC VOLTAGE: 3.3V
4. VIEWING DIRECTION: 6.0° CL OCK
5. OPERATING TEMP.: 0° C-50° C
6. STORAGE TEMP.: -10° C-60° C
7. DRIVE MODE: 1/16 DUTY, 1/5 BIAS
8. BACKLIGHT: YELLOW GREEN/BOTTOM BACKLIGHT/5.0V
9. OTHER:

NOTE:

DESCRIPTION:

C/D

SCALE: FIT	TINSHARP	TINSHARP
SHEET: 1 OF 1	INDUSTRIAL CO., LTD.	INDUSTRIAL CO., LTD.
PROJECTION	MODEL	SERIAL NUMBER
UNIT: mm	TC1602D-19	LXL0860
APP:	CHK:	DWN:
DATE:	DATE:	DATE: